



**Rheinhold & Mahla**

Since 1887



Materials & Accessories



**R&M Products**

# Table of contents

**Introduction**

**Materials Accessories**

■ Type R&M SUBMAT™

1

# Interior outfitting manufactured by the R&M Group

The products of the R&M Group provide efficient, individual and turnkey solutions for interior outfitting. The extensive portfolio ranges from doors, wet units and pods to furniture, which are manufactured at our production facilities in Wismar and in Rostock (Germany) as well as in Kunshan (China). With our own modern product facilities, we are able to offer very flexible according to customers' requirements and wishes. We consider simultaneously the design as well as economic issues, which play a key role in our daily business.

All the high-quality products meet the highest standards and the most stringent international guidelines. They are characterized with the best fire, noise and vibration protection ensuring comfort and safety on board for passengers as well as crew members. We deliver just-in-time to any desired location in the world.

## Production facilities

### Wismar

In Wismar, we produce furniture according to standard specifications and individual customer requirements. Our excellent design solutions are continuously developed. Thanks to the latest computerized numerical control (CNC) machines, we are also able to meet the most specific requirements in a short turnaround time while maintaining our quality guarantee. Furthermore, together with our suppliers we can offer a range of products, from sophisticated stainless-steel work and superior solid surfaces to creative mirrors, glass features, and high-grade upholstery.

### Rostock

In Rostock, which is very close to Wismar, our central warehouse and logistics center is located as well as the facility for final assembly of our furniture manufacture from Wismar.

### Kunshan

Further production facility is located in Kunshan, near Shanghai. It is the larger facility, where we manufacture for example wet units, doors, wall and ceiling systems. European standards of quality and international logistic guidelines are strictly observed during the entire manufacturing process. The team is multinational and has long-term experience and knows each important characteristics of products.

### Our competences

- Individual customizations and configurations on request
- Complete installation for electrical, air-conditioning and sprinkler systems
- Just-in-time delivery
- Guarantee of quality
- Products at best price-performance ratio
- Assembly line for prefabricated wet units and cabins on site
- Tested and approved structural materials
- Worldwide shipping, assembly and installation on board

## Quality management system

- Quality management system in accordance with the international norm ISO 9001
- Quality assurance system are compliant with Maritime Equipment Directive, Modul D
- It consists of incoming inspection per category, in-process quality control and outgoing inspection and release to delivery
- Quality standards are monitored by the multicultural R&M Quality Management Team

## Materials & Accessories

# Type R&M SUBMAT™

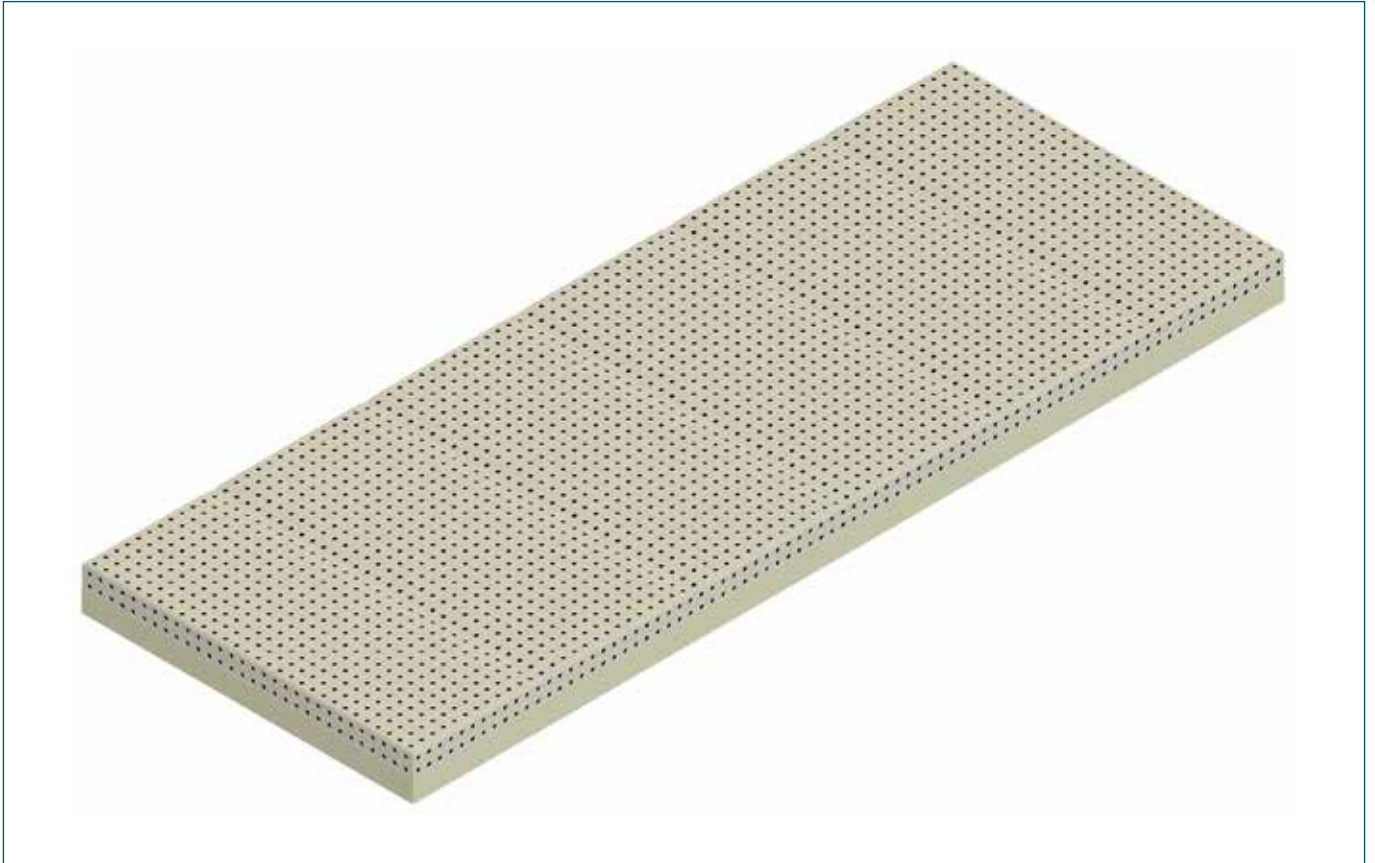

The R&M SUBMAT™ is a high-quality insulation material based on earth alkali silicate fibers, that was specially designed for the common needs of shipbuilding industry. With its characteristics, it fulfills both acoustic and thermotechnical standards. Due to the high degree of prefabrication it can be fitted according to the demands on site before installation. The multilayered blanket is free of binder content and contains an integrated water-vapor barrier.

The design of the R&M SUBMAT™ and all components have been tested and approved according to international standards.

Materials & Accessories

# Type R&M SUBMAT™

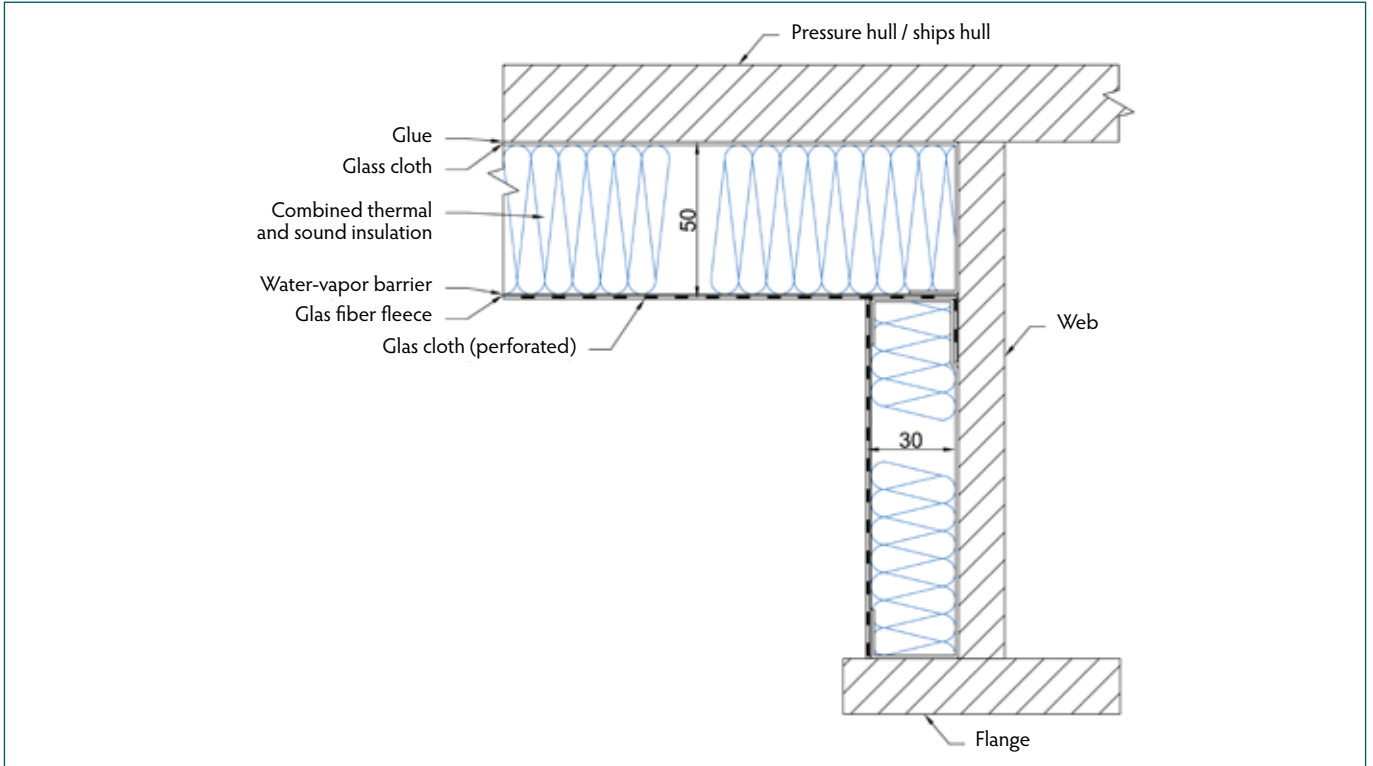

Technical data	R&M SUBMAT™
Composition	prefabricated multilayer blanket
Fire classification	non-combustible
Dimensions - Standard - Customized	30 / 50 x 380 x 1,000 mm (thickness x width x length) up to 100 x 1,000 x 3,000 mm (thickness x width x length)
Density	96 kg/m <sup>3</sup>
Thermal conductivity	at 25°C approx. 0.035 W/mK
Temperature range	up to 200°C
Weight - 30 mm - 50 mm	4.0 kg/m <sup>2</sup> 6.0 kg/m <sup>2</sup>
Certification	MED, USCG, WIWEB

# Contact us

## **R&M Alvedoor (Kunshan) Co. Ltd.**

Building D of Euro-Park,  
78 Gucheng Road (M) Kunshan  
215 300 Kunshan/P.R. of China  
phone +86 512 5518 0328  
china@rm-group.com

## **R&M Ship Technologies GmbH**

Werftstraße 4  
23966 Wismar/Germany  
phone +49 3841 3263-0

Petridamm 11c  
18146 Rostock/Germany  
phone +49 381 6584-100-0  
germany@rm-group.com

## **Image credit**

Peter Neumann

## **Important notice**

All 2D and 3D drawings in this product catalogue are only illustrations and guidelines. The specifications given in our quotations are valid only.

## **Publisher**

### **R&M Group**

R&M International GmbH  
Schellerdamm 22-24 ■ 21079 Hamburg/Germany  
www.rm-group.com

Reproduction, in whole or in part, is only permitted with the explicit written consent of the publisher.

Issue RM-2020-1-E